

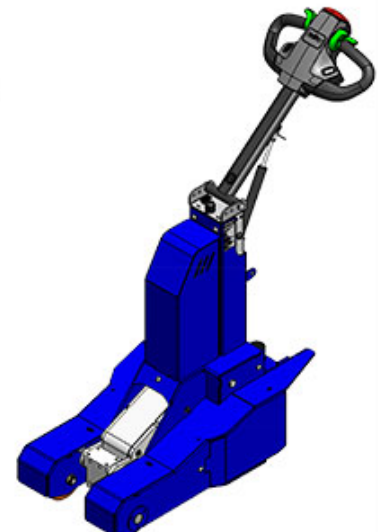

M16
Electric Pedestrian Tow Tug

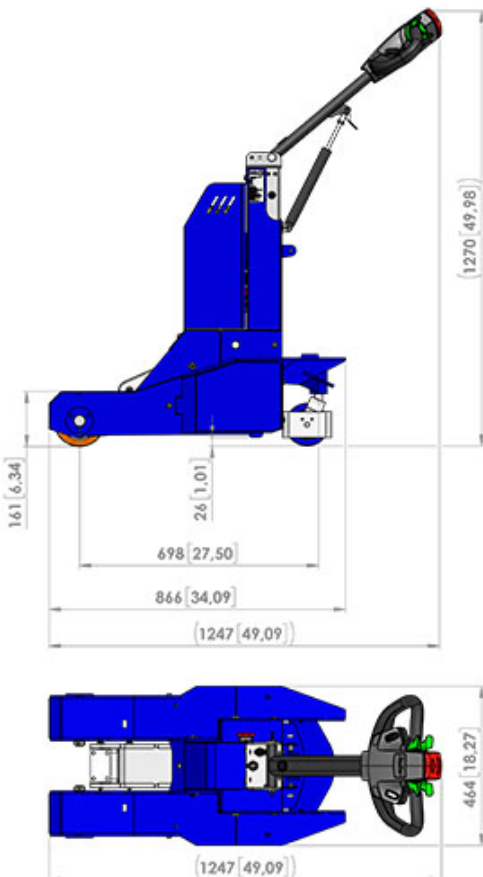

Frame characteristics		Tolerance	M.U.	.
1.80	Frame made of			Steel
1.81	Basic process			Sandblasting
1.82	Anti-Corrosion Treatment (on customer demand only)			
1.83	Frame treatment			Polyester powder coating

Safety data		Tolerance	M.U.	.
2.02	Emergency reverse button			On tiller head
2.06	Power supply disconnection device / Emergency stop			Detachable power connector
2.10	Acoustic signaling			Beeper
2.11	Drive controls			Maintained action switch
2.15	Wheels			Wheels protection

Performances		Tolerance	M.U.	.
3.01	Max. forward speed	± 5 %	km/h	4
3.02	Max. backward speed	± 5 %	km/h	4
3.10	Max. lifting capacity		kg	1800
3.11	Max.towing capacity on flat ground (max 3 min) **		kg	6000
3.23	Max towing force at hook **		N	900
3.38	* Load capacity is subject to kind of slope , kind of floor and operating time			
3.40	** While the force expressed in N at the hook remains unchanged, the following circumstances may affect the towing capacity expressed in KG : type of ground on which the towing is performed, the use (or not) of ballasts and type of wheels mounted on the vehicle and on the trailer			

Technical data of hydraulic tilting system		Tolerance	M.U.	.
3.80	System voltage		V	24

Drive controls		Tolerance	M.U.	.
4.01	Type of control			Tillerhead
4.02	Type of start control			Butterfly lever
4.05	Lifting system operated by			Lever switch

Standard batteries		Tolerance	M.U.	.
5.01	Batteries			1
5.02	Batteries type			Traction - Lithium
5.03	Battery voltage		V	24
5.04	Nominal Capacity 5 h		Ah	50
5.06	Weight of each battery		kg	21

Technical data of standard charger		Tolerance	M.U.	.
6.01	Battery charger			External - high frequency
6.02	Input voltage		V	110/240
6.03	Input Frequency		Hz	50-60

Drive motor		Tolerance	M.U.	.
7.03	Engine			Electric
7.05	Engine voltage		V	24

Technical data		Tolerance	M.U.	.
8.01	Transmission system			Mechanical + Chain
8.02	Transmission lubrication			In oil bath
8.06	Service brake			Electronic
8.08	Parking brake			Electro-Mechanical
8.22	Lifting system operated by			Manual

Weight		Tolerance	M.U.	.
9.01	Weight without batteries		kg	142
9.20	Weight		kg	163

Dimensions		Tolerance	M.U.	.
10.14	Wheelbase		mm	698

Standard wheels		Tolerance	M.U.	.
11.01	Drive wheels			2
11.03	Pivoting wheels no.			2
11.05	Tyres			Polyurethane (oil resistant)
11.16	Pivoting wheel size			Ø 125 X 2